

**LEGENDA**

- LIMITE**
- Limita teren beneficiar propus pentru introducerea in intravilanul localitatii
  - Limita parcele cadastrale existente
  - Limita parcele PUZ existente

- ZONIFICARE FUNCTIONALA**
- Canal ANIF existent, Hcn 262, 271, 275
  - Teren faneata
  - Teren arabil
  - Teren curti constructii
  - Constructii avizate existente

- CAI DE CIRCULATII EXISTENTE**
- Drum national existent (DN 69)
  - Drum de centura existent
  - Drumuri de exploatare existente (De 266/3, De 256/1/4, De 272)
  - Acces parcela

**DISFUNCTIONALITATI**  
- canale care traverseaza parcela luata in studiu

**COORDONATE IN SISTEM STEREO 70**

Nr. Pct.	Coordonate pct.de contur	Lungimi laterale D(i,i+1)	Nr. Pct.	Coordonate pct.de contur	Lungimi laterale D(i,i+1)	
	X [m]	Y [m]		X [m]	Y [m]	
1	486567.550	204295.853	777.04	43	486627.571	205160.621
2	486834.999	205025.418	29.49	44	486636.117	205185.116
3	486807.661	205036.470	29.42	45	486624.746	205194.177
4	486780.583	205047.497	29.36	46	486549.603	205254.048
5	486753.163	205058.501	29.25	47	486535.851	205232.954
6	486726.047	205069.463	7.07	48	486519.423	205199.999
7	486721.174	205074.580	23.94	49	486503.935	205167.419
8	486703.146	205090.335	7.96	50	486518.815	205173.286
9	486697.151	205095.575	14.63	51	486514.085	205163.620
10	486685.822	205104.836	24.50			
11	486666.855	205120.341	42.32			
12	486634.087	205147.128	10.70			
13	486624.350	205151.564	2.07			
14	486622.468	205152.421	49.31			
15	486573.406	205157.322	24.18			
16	486549.342	205159.725	42.55			
17	486506.806	205158.478	14.26			
18	486495.886	205149.303	224.18	52	48643.546	205262.956
19	486324.247	205005.092	28.23	53	486516.090	205248.830
20	486304.079	204985.337	11.49	54	486440.820	205344.800
21	486293.802	204980.188	19.31	55	486402.765	205291.317
22	486276.416	204971.789	6.17	56	486293.513	205009.970
23	486271.951	204967.529	68.54	57	48613.444	205085.856
24	486248.299	204903.196	47.03	58	486402.457	205083.134
25	486231.750	204859.169	72.19	59	486433.036	205109.937
26	486209.148	204790.613	50.59	60	486460.582	205133.386
27	486196.432	204741.644	68.53	61	486488.189	205158.437
28	486182.088	204674.628	142.58	62	486527.655	205242.509
29	486253.826	204551.415	135.75			
30	486209.581	204423.081	19.48			
31	486227.528	204415.507	42.81			
32	486246.969	204398.863	27.30			
33	486292.784	204389.992	49.83			
34	486339.911	204373.797	50.65			
35	486387.815	204357.336	23.14			
36	486409.702	204349.815	21.25			
37	486429.803	204342.907	19.30			
38	486448.057	204336.635	8.77			
39	486456.285	204333.593	29.24			
40	486463.978	204324.200	29.35			
41	486511.776	204314.771	29.42			
42	486539.633	204305.323	29.48			

Nr. Pct.	Coordonate pct.de contur	Lungimi laterale D(i,i+1)	
	X [m]	Y [m]	
52	48643.546	205262.956	35.10
53	486516.090	205248.830	96.24
54	486440.820	205344.800	65.64
55	486402.765	205291.317	301.81
56	486293.513	205009.970	20.35
57	48613.444	205085.856	117.88
58	486402.457	205083.134	40.66
59	486433.036	205109.937	36.18
60	486460.582	205133.386	37.28
61	486488.189	205158.437	92.87
62	486527.655	205242.509	25.90

EXISTENT			
CF nr.	Nr. Cad	suprafata mp	%
Teren curti constructii	409748	CC274/1/1	71700, 8,95%
Teren curti constructii	409824	CC274/1/2	56400, 7,04%
Teren arabil	409740	A274/1/3	41000, 5,12%
Teren arabil	409779	A274/1/4	41600, 5,20%
Teren arabil	409774	A274/1/5	18700, 2,34%
Teren arabil	409850	A274/1/6	17000, 2,12%
Teren arabil	409746	A274/1/7	17500, 2,19%
Teren arabil	409783	A282/1/a	22925, 2,86%
Teren arabil	409848	A282/1/b	22925, 2,86%
Teren arabil	409743	A282/1/c	22925, 2,86%
Teren arabil	409739	A282/1/d	22925, 2,86%
Teren arabil	409851	A260/1/1/1	400, 0,05%
Teren arabil	409852	A260/1/2/1	6100, 0,76%
Teren arabil	409853	A265/1/1/1/1	25000, 3,12%
Teren faneata	409854	F261/1/1/1	8400, 1,05%
<b>Total teren RAURON CONSTRUCT SRL</b>			<b>395500, 100,00%</b>
Hcn 262			1178
Hcn 275			4878
Hcn 271			1874
De 272			1785
<b>Total</b>			<b>800715</b>

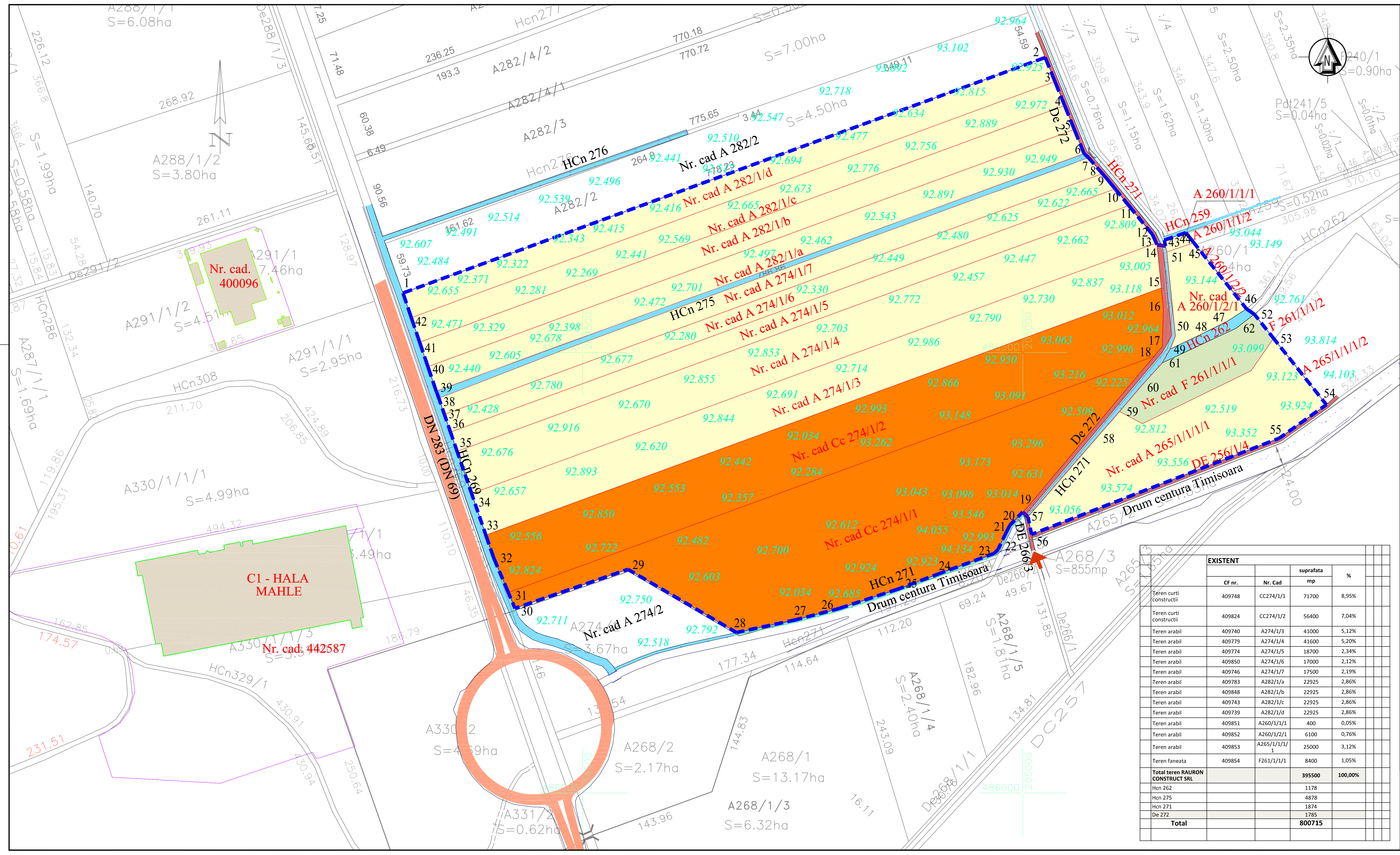

ISO 9001 QUALITY MANAGEMENT SYSTEM

MELVIN S.R.L. av. Tudor Vladimirescu nr. 19A, blocu 9 300 175 RD - TIMISOARA 025611102 e-mail: melvin.offic@melvin.com

Proiect: MODIFICARE PUZ "SPATII DE DEPOZITARE, SERVICII SI COMERT" obtinut cu HCL nr. 322/03.08.2007

Nr. proiect: U 376/2017

Beneficiar: RAURON CONSTRUCT SRL

FAZA: A.O.

Titlu planșă: SITUATIA EXISTENTA

Planșă: U 376.02

SEF PROIECT: arh. Lovredana PESCARU

DIRECTOR: Ing. Daniel PESCARU

PROIECTAT: arh. Lovredana PESCARU

DESENAT: arh. Radu BORCOMAN

SEMNATURA: [Signature]

SCALA: 1:2000

DATA: OCTOMBRIE 2017

500x1000