

# LEGENDA

	S <sub>zona verde</sub> =872,22 m <sup>2</sup>
	S <sub>parcaj</sub> =1185,40 m <sup>2</sup>
	Capacitate <sub>parcaj</sub> = 49 locuri auto 7 locuri betoniere
	S <sub>parcaj camioane (16,80 m lungime)</sub> =611,18 m <sup>2</sup>
	S <sub>statie beton</sub> =971,22 m <sup>2</sup>
	S <sub>c.(Hmax. = 9m)</sub> =1300,00 m <sup>2</sup>
	S <sub>c.(Hmax. = 6M)</sub> =972,00 m <sup>2</sup>
	S <sub>c.(Hmax. = 4 m)</sub> =920,00 m <sup>2</sup>
	S <sub>platforme betonate</sub> =1132,85m <sup>2</sup>
	S <sub>carosabila</sub> =2620,31m <sup>2</sup>

S<sub>teren existent</sub>=10.000 m<sup>2</sup>  
 S<sub>teren cedat</sub>=26.00 m<sup>2</sup>  
 S<sub>teren propunere</sub>=9.974 m<sup>2</sup>  
 P.O.T.=32,00 %  
 C.U.T.=0,32

- LIMITA ZONA STUDIATA
- LIMITA DE PROPRIETATE - propusa
- aliniament la 2 si 3m fata de limita laterala de proprietate

LINEIE ELECTRICE DE TENSIUNE MEDIE  
propusa spre ingropare

- ACCES AUTO
- ACCES PIETONAL

## CONSTRUIRE STATIE BETOANE ECOLOGICA + HALE INDUSTRIALE, INCLUSIV BIROURI PENTRU PRODUCTIE / DEPOZITARE / SERVICE ( in regim maxim de inaltime)

C.F. nr. 440019  
 C.U. nr. 1504 din 10.04.2018

### PLAN DE INCADRARE IN LOCALITATE

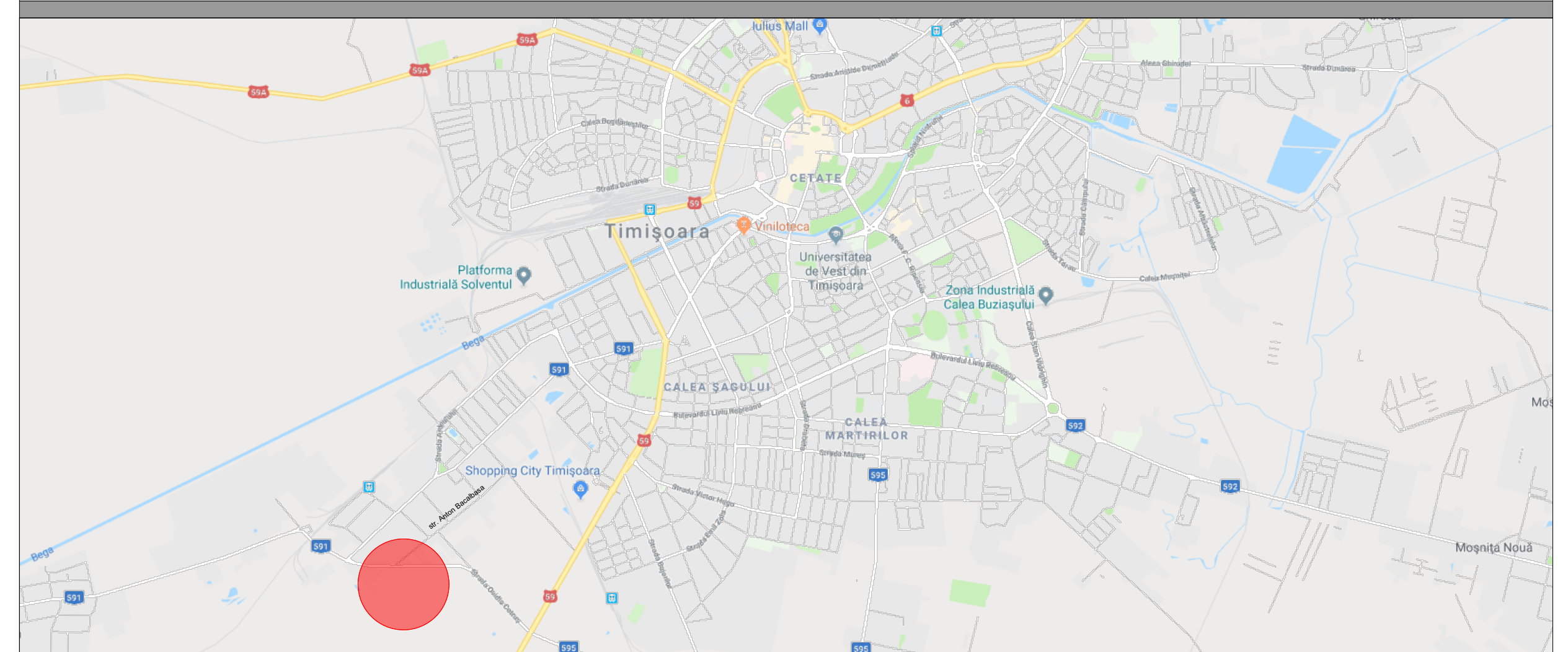

### PLAN DE INCADRARE IN P.U.G.

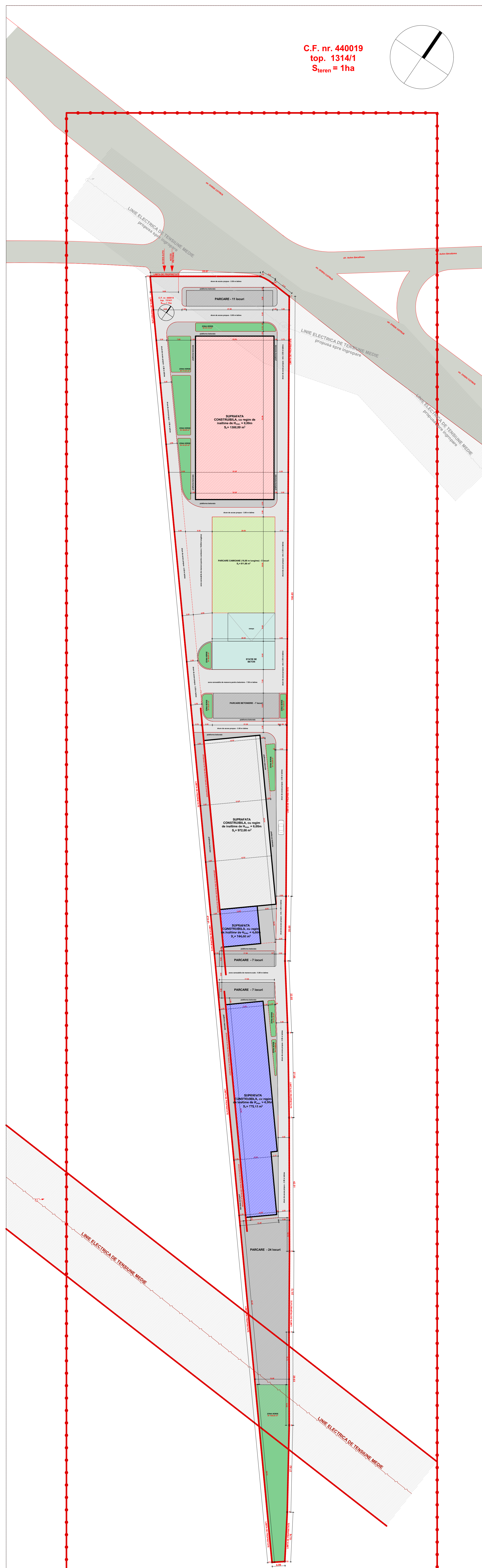
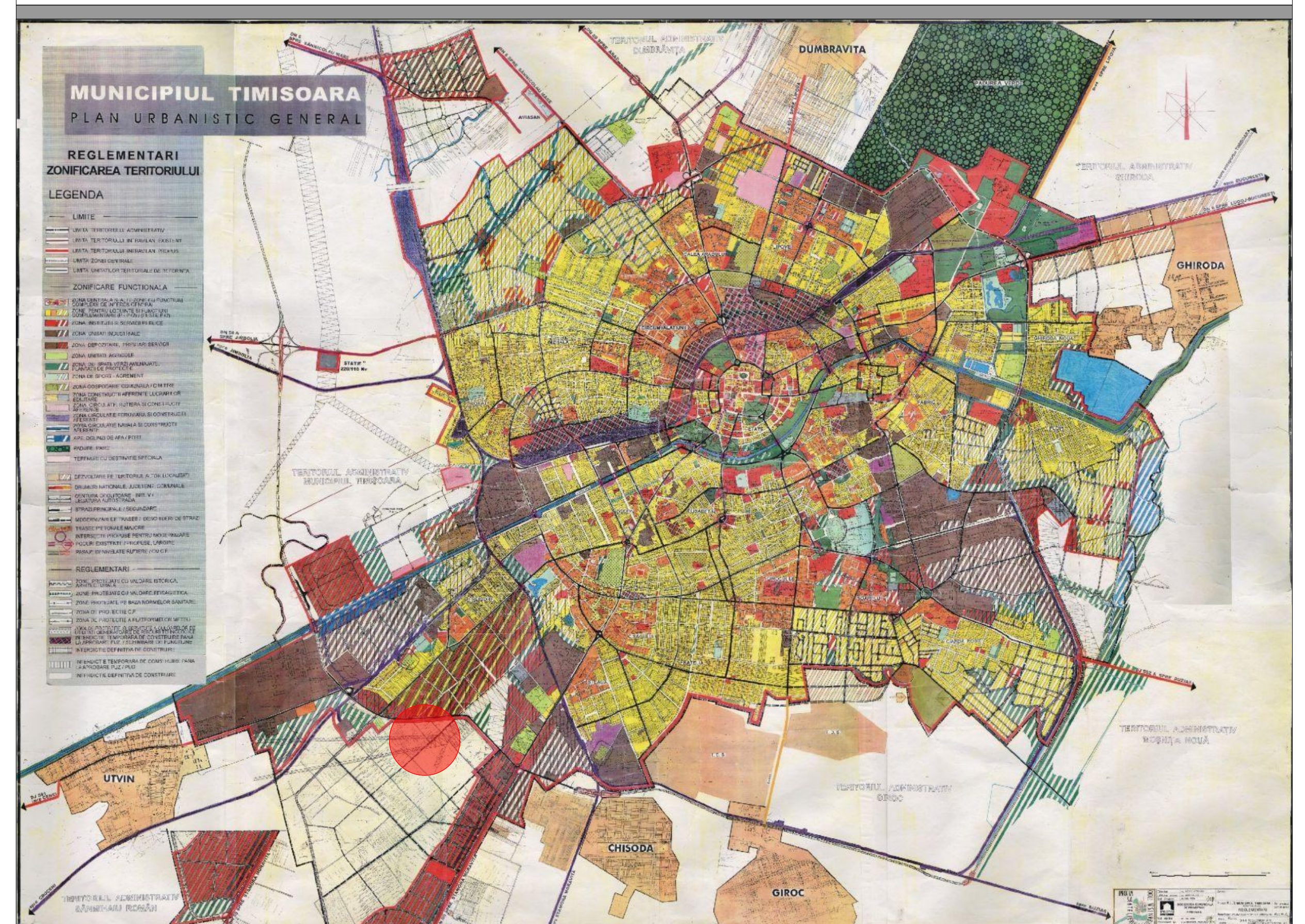

### PLAN DE REGLENTARI URBANISTICE, sc. 1:500

VERIFICATOR	CERNTA	BENEFICIAR:	PROIECT
	INGINIERING & CONSULTING	S.C. PREFARM CONSTRUCT s.r.l.	1410019
NUME	SEMANTURA	TITLUL PROIECTULUI:	FAZA
SEF PROIECT	1:500	CONSTRUIRE STATIE BETOANE ECOLOGICA + HALE INDUSTRIALE INCLUSIV BIROURI PENTRU PRODUCTIE / DEPOZITARE / SERVICE ( in regim maxim de inaltime)	S.O.
PROIECTAT	DATA:	08.2018	PLANSA
DESEINAT	TITLUL PLANSEI:	PLAN DE REGLENTARI URBANISTICE	A.03