

LEGENDA

	S _{zona verde} =872,22 m ²
	S _{parcaj} =1185,40 m ²
	Capacitate _{parcaj} = 49 locuri auto 7 locuri betoniere
	S _{parcaj camioane (16,80 m lungime)} =611,18 m ²
	S _{statie beton} =971,22 m ²
	S _{c.(Hmax. = 9m)} =1300,00 m ²
	S _{c.(Hmax. = 6M)} =972,00 m ²
	S _{c.(Hmax. = 4 m)} =920,00 m ²
	S _{platforme betonate} =1132,85m ²
	S _{carosabila} =2620,31m ²

S_{teren}=9.974 m²
P.O.T.=32.00 %
C.U.T.=0,32

- LIMITA ZONA STUDIATA
- LIMITA DE PROPRIETATE - propusa
- aliniament la 2 si 3m fata de limita laterala de proprietate

LINEIE ELECTRICE DE TENSIUNE MEDIE propusa spre ingropare

- ACCES AUTO
- ACCES PIETONAL

CONSTRUIRE STATIE BETOANE ECOLOGICA + HALE INDUSTRIALE, INCLUSIV BIROURI PENTRU PRODUCTIE / DEPOZITARE / SERVICE (in regim maxim de inaltime)

C.F. nr. 440019
C.U. nr. 1504 din 10.04.2018

PLAN DE INCADRARE IN LOCALITATE

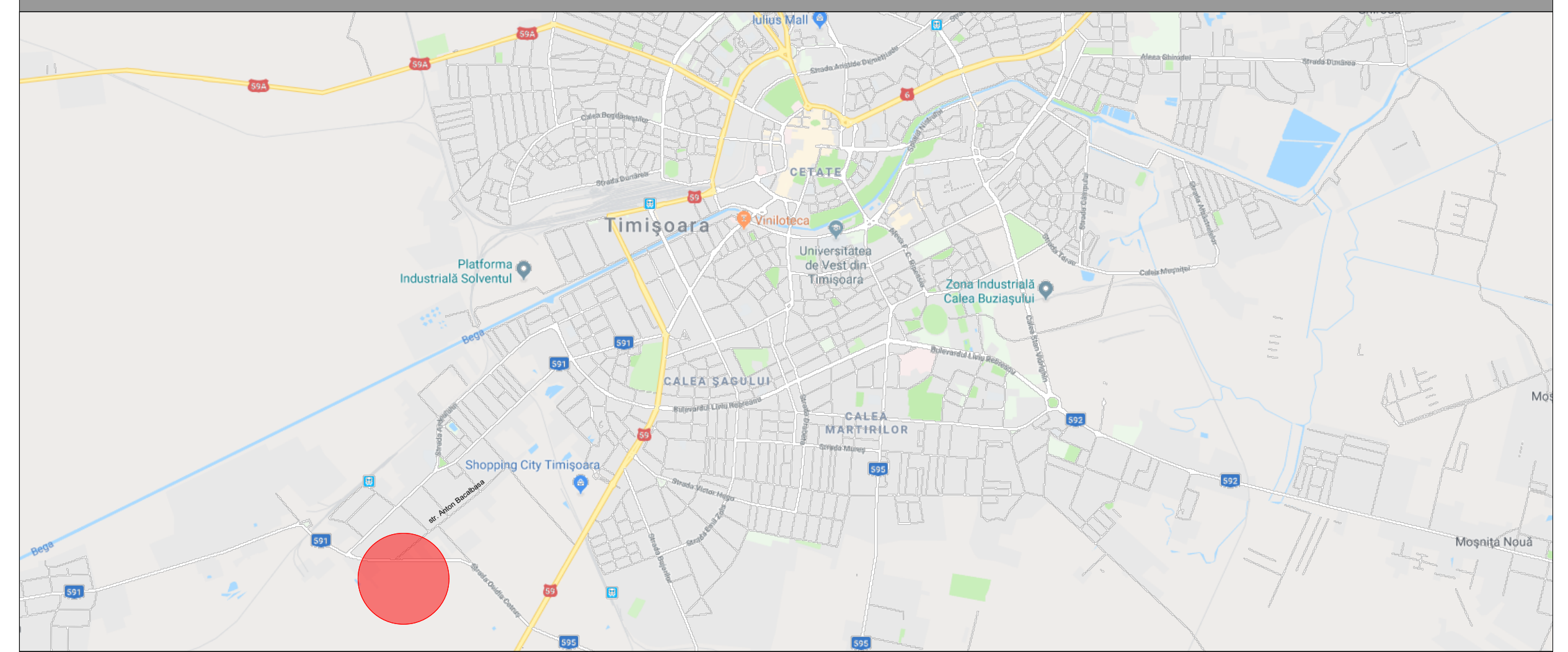

PLAN DE INCADRARE IN P.U.G.

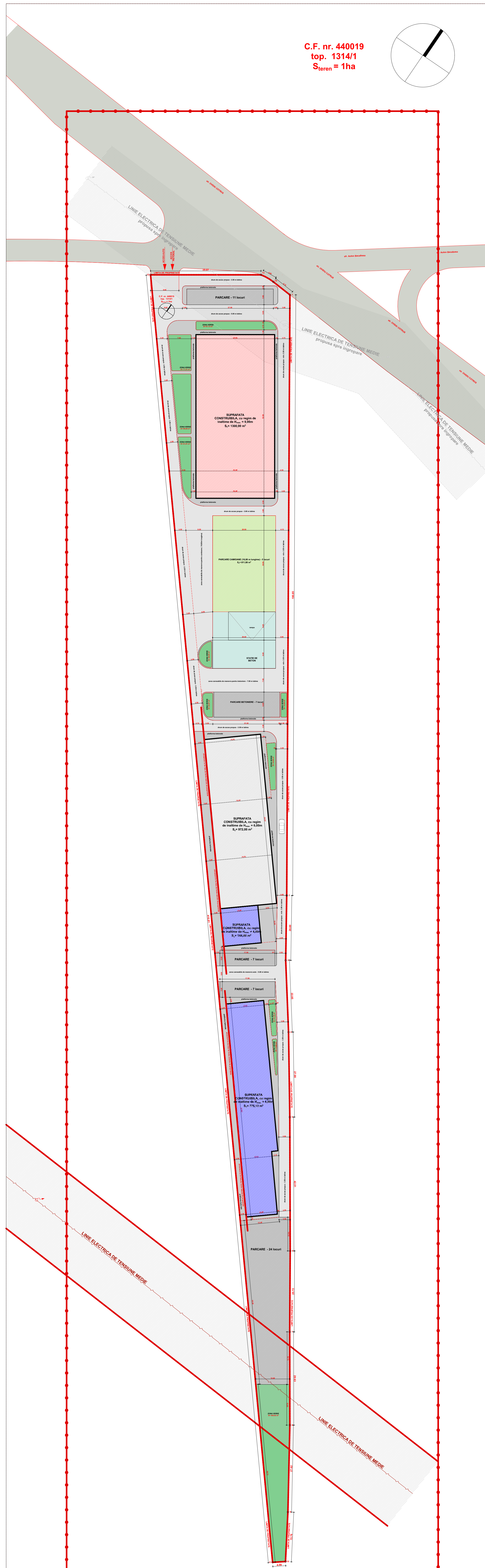
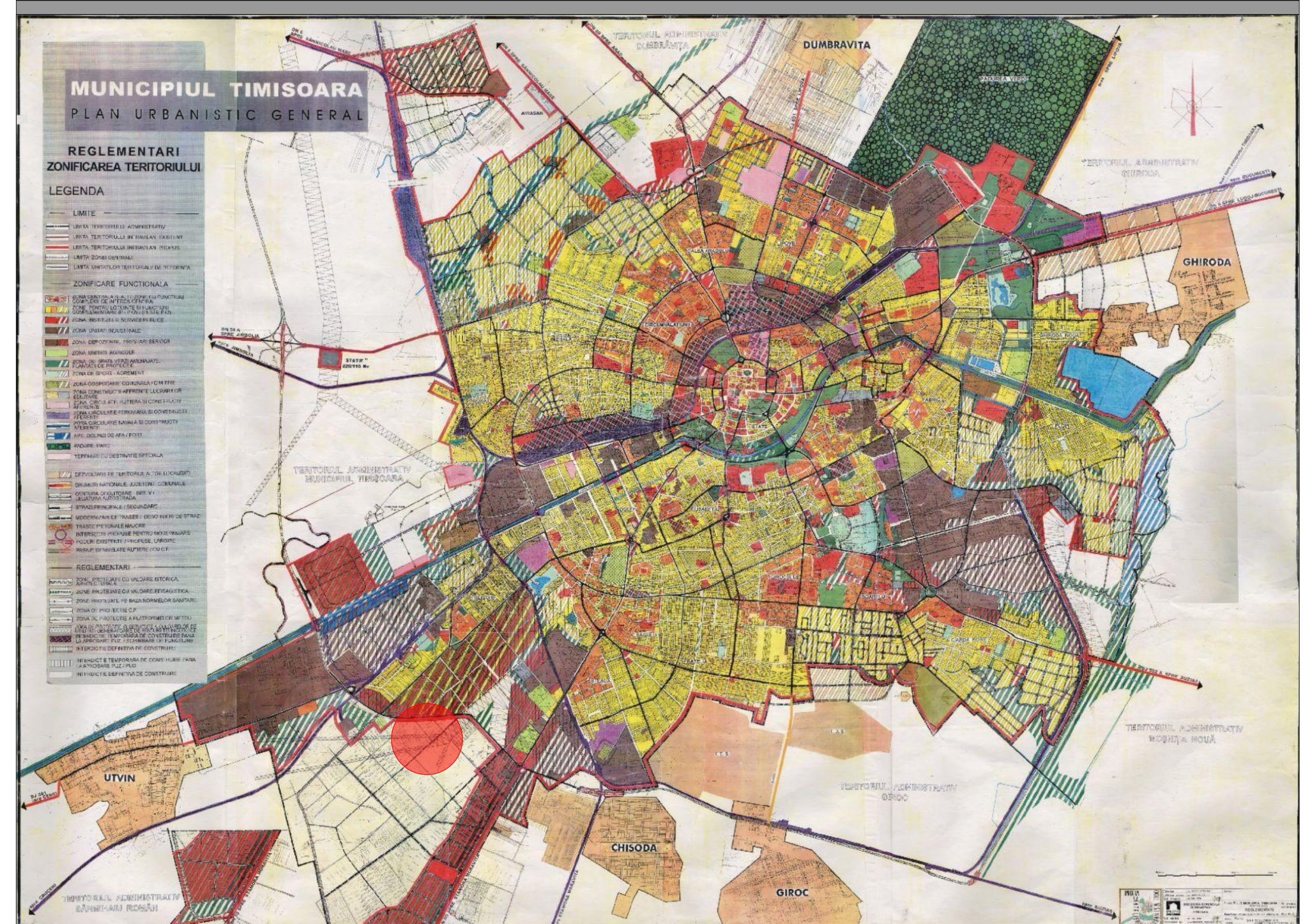

C.F. nr. 440019
top. 1314/1
S_{teren} = 1ha

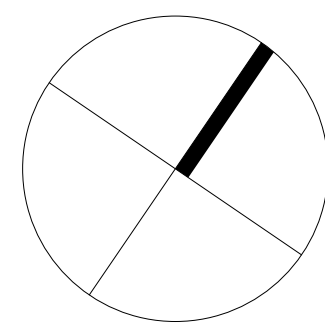

PLAN DE REGLENTARI URBANISTICE, sc. 1:500

VERIFICATOR	CERNTA	BENEFICIAR:	PROIECT
	INGINIERING & CONSULTING	S.C. PREFARM CONSTRUCT s.r.l.	1410019
NUME	SEMANTURA	TITLUL PROIECTULUI:	FAZA
SEF PROIECT	1:500	CONSTRUIRE STATIE BETOANE ECOLOGICA + HALE INDUSTRIALE INCLUSIV BIROURI PENTRU PRODUCTIE / DEPOZITARE / SERVICE (in regim maxim de inaltime)	S.O.
PROIECTAT	DATA:	08.2018	PLANSA
DESENAT	TITLUL PLANSEI:	PLAN DE REGLENTARI URBANISTICE	A.03