

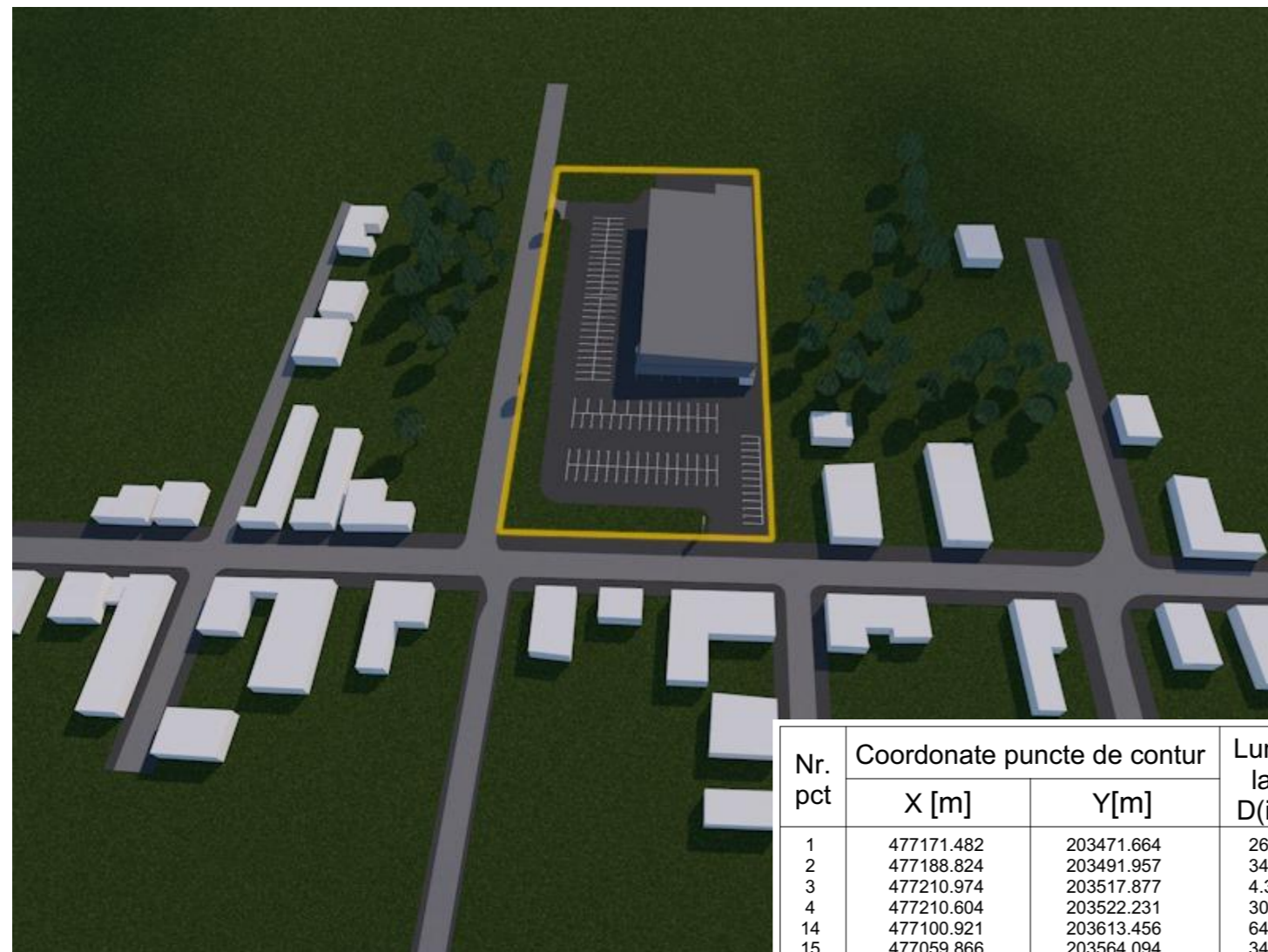

AVIZ DE OPORTUNITATE Intocmire PUZ si RLU - Construire supermarket LIDL si amenajare locuri de parcare in incinta , amplasare panouri publicitare pe teren proprietate si fatada, amplasare totem, amenajare accese, imprejmuire proprietate, organizare de santier

mun. Timisoara, jud. Timis, str. Nicolae Andreescu

CF 447321, CF 447320, CF 447319, CF 447318, CF 447317

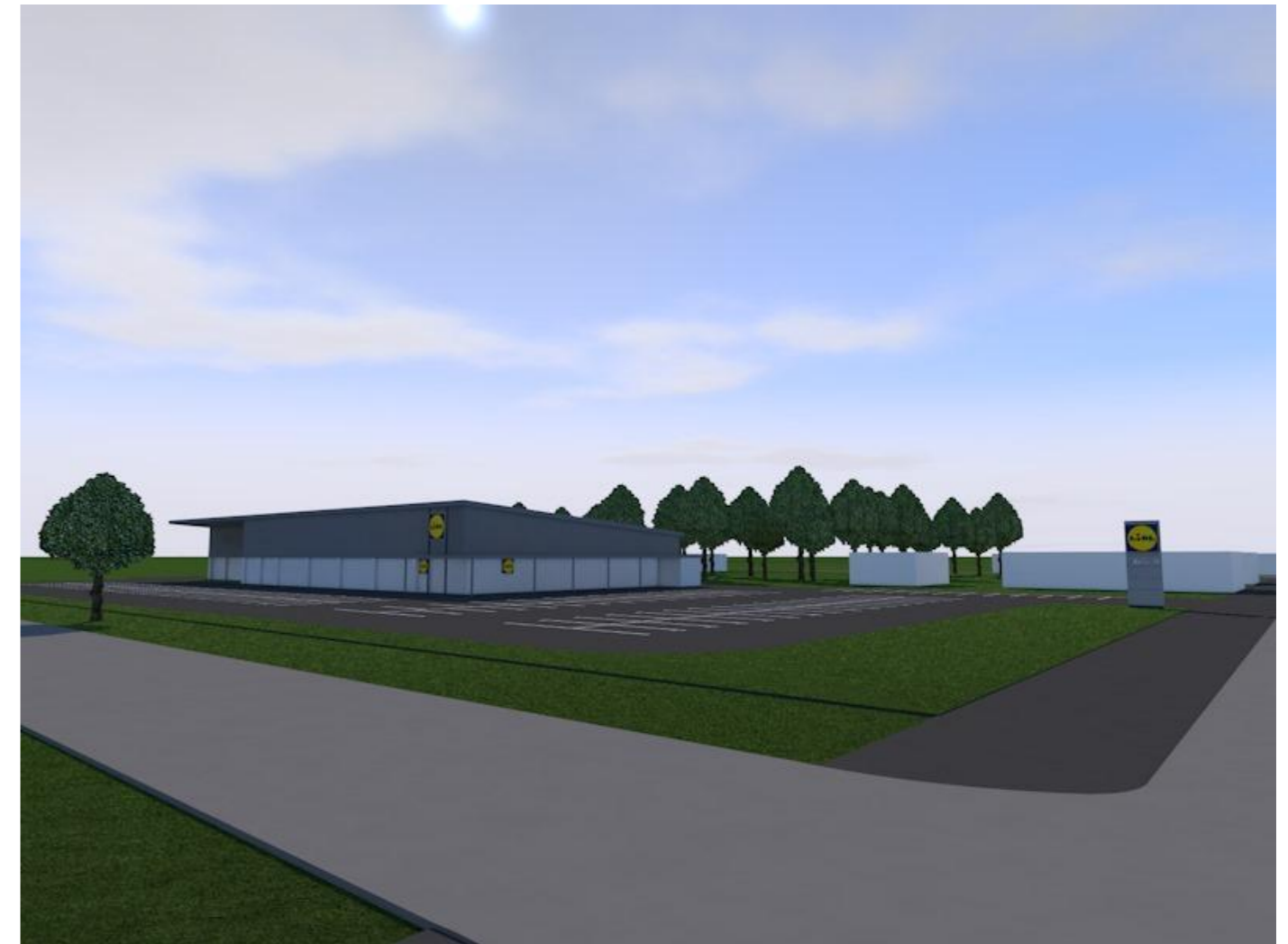

Nr. pct	Coordonate puncte de contur		Lungimi laturi D(i,i+1)
	X [m]	Y[m]	
1	477171.482	203471.664	26.694
2	477188.824	203491.957	34.095
3	477210.974	203517.877	4.370
4	477210.604	203522.231	30.642
14	477100.921	203613.456	64.204
15	477059.866	203564.094	34.000

Verficator/ Expert:			referat/ expertiza nr.
 S.C. LEVANT PROJECT S.R.L. timisoara, str. alexandru macedoski, nr. 1 tel: 0744 960 048, email: miron_suteu@yahoo.com	Beneficiar:		SC LIDL ROMANIA SCS
	Titlu proiect:		ETAPA1 Intocmire PUZ si RLU - Construire supermarket LIDL si amenajare locuri de parcare in incinta , amplasare panouri publicitare pe teren proprietate si fatada, amplasare totem, amenajare accese, imprejmuire proprietate, organizare de santier
Verificat:	arh. Carmen Falnita	SEMNATURA	
Proiectat si desenat:	arh. Ioana Petruti arh. Bianca Penciu arh. Luiza Isabela Dan		
Scara:		Data:	aprilie/2019
		Amplasament:	mun. Timisoara, jud. Timis, str. Nicolae Andreescu CF 447321, CF 447320, CF 447319, CF 447318, CF 447317
		Titlu plansa:	RANDARI VOLUMETRICE
			Proiect nr: 45/2019 Faza: P.U.Z. - ETAPA 1 Plansa nr: A.06