

08:13

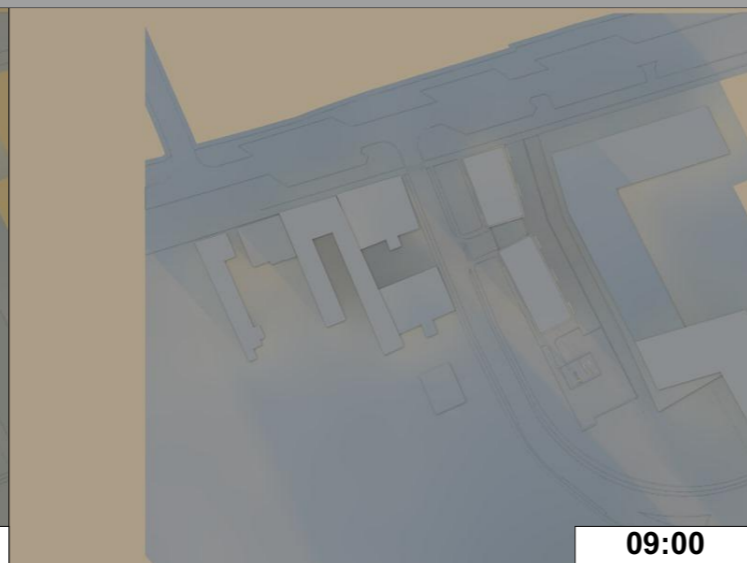

09:00

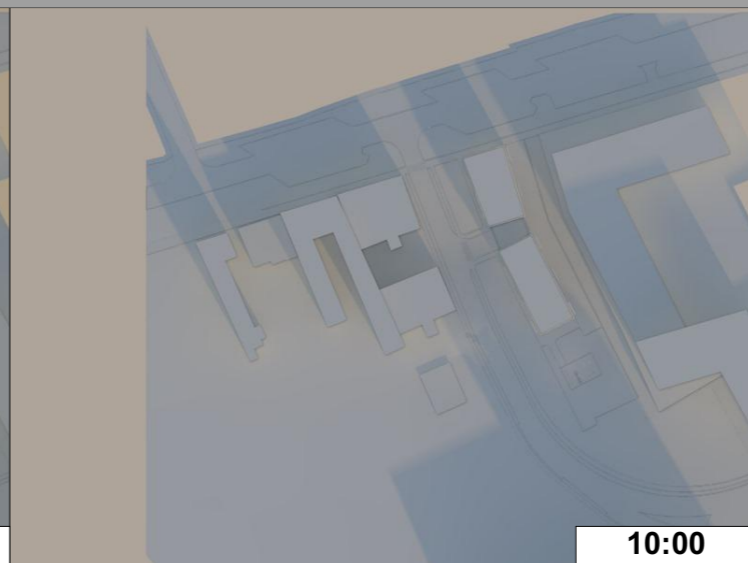

10:00

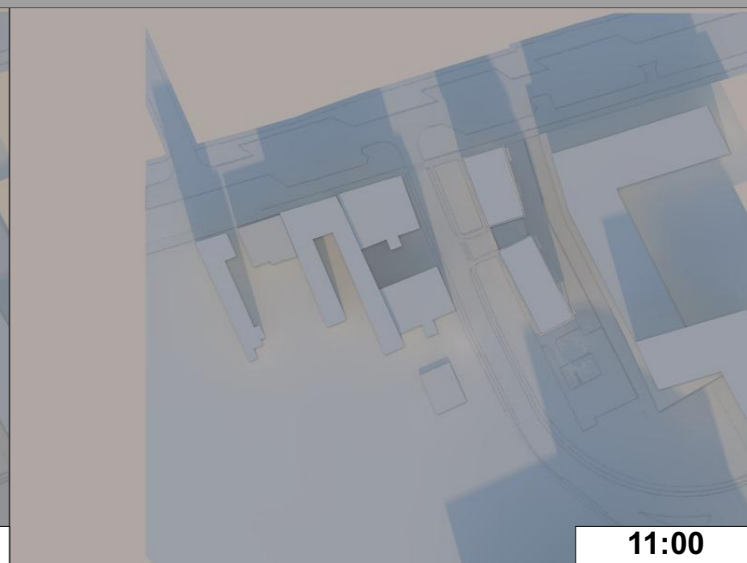

11:00

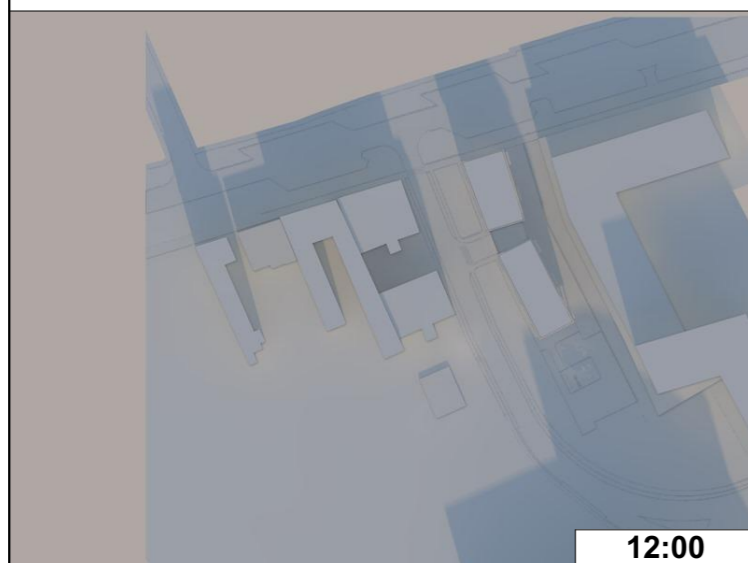

12:00

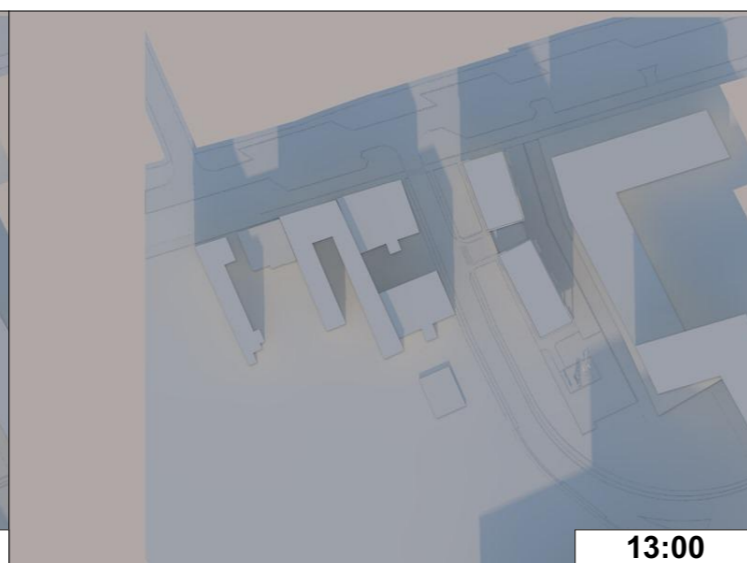

13:00

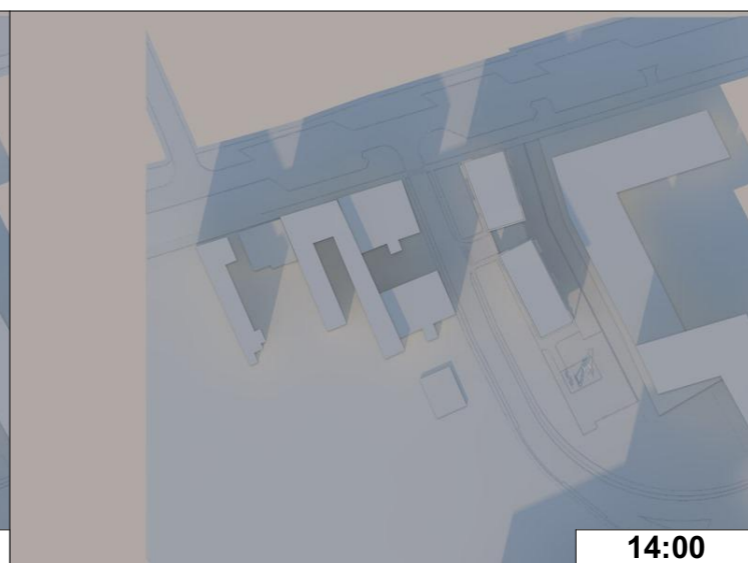

14:00

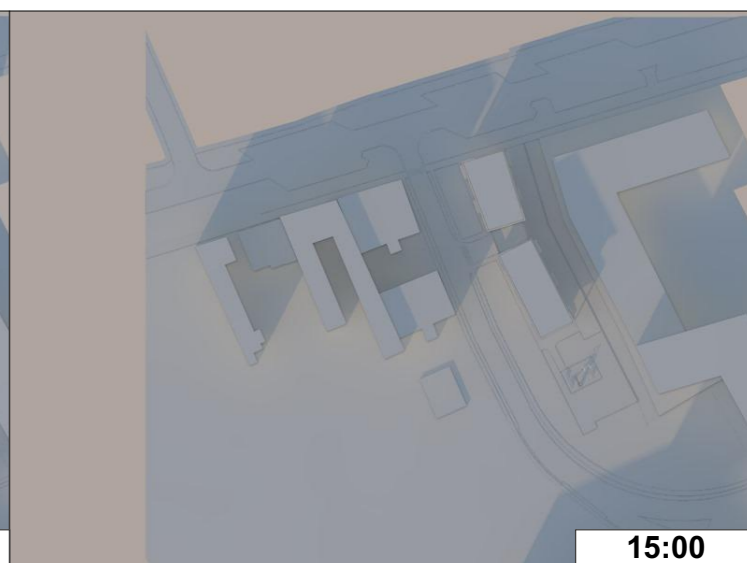

15:00

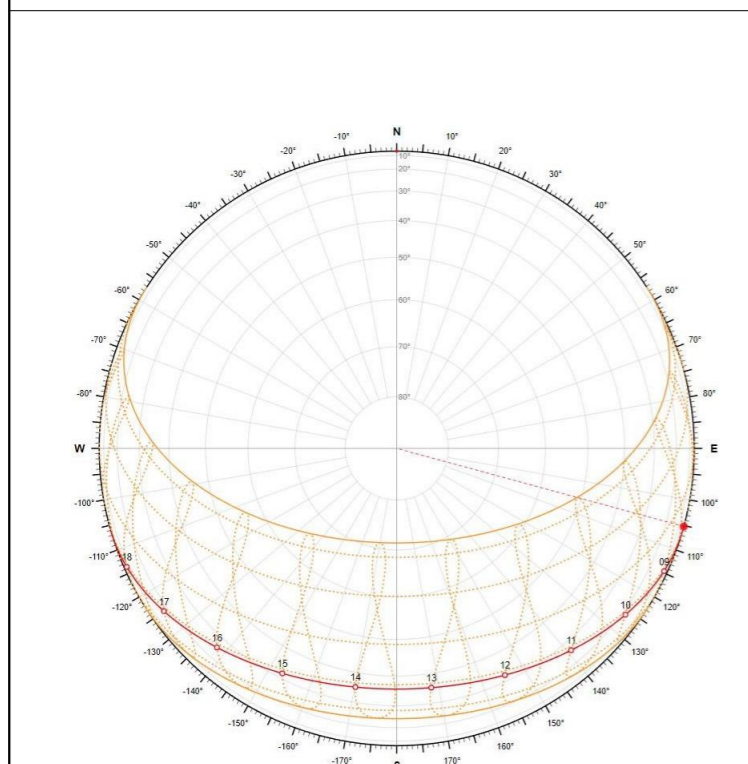

**DIAGRAMA SOLARA**  
**TIMISOARA, STR. ROMULUS, NR 37**  
 45°96'23.57" LAT. NORD  
 23°56'40.67" LONG. EST  
 RASARIT SOARE : 08:13  
 APUS SOARE : 16:54

**Nota:**  
 Studiul de insorire a fost intocmit la data solstitiului de iarna, 22.12. Prezentul studiu conecteaza imagini edificatoare, din ziua cea mai nefavorabila a anului - solstitiul de iarna. Se poate observa faptul ca imobilul proiectat **asigura iluminarea naturala a accladirilor invecinate.**

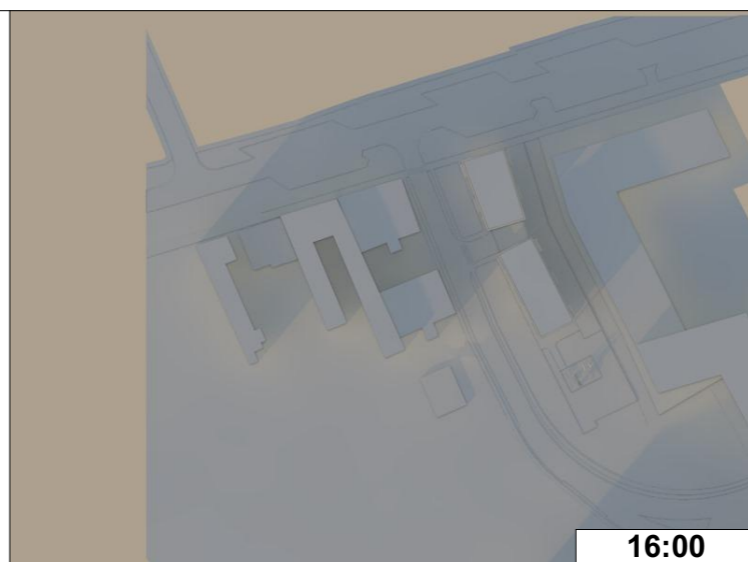

16:00

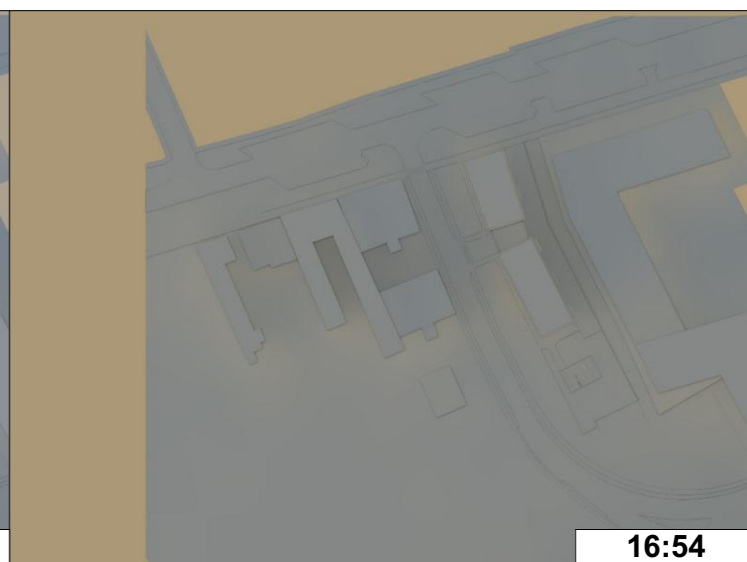

16:54

Blv. Banul Mărăcine nr. 13A  
 300398 | Timișoara | România  
 0724.213.114  
 office@qconsultants.ro  
 www.qconsultants.ro



BENEFICIAR:	<b>AL KADDAH GHASSAN</b>	PR. NR.:	206/2018
AMPLASAMENT:	<b>Mun. Timișoara, str. Romulus, nr. 37, Județul TIMIȘ C.F.NR. 415360, NR.TOP. 12414, 12413/1</b>	FAZA:	AVIZ OPORTUNITATE
TITLUL PROIECTULUI:	<b>CONSTRUIRE 2 IMOBILE DE LOCUINȚE COLECTIVE ÎN REGIM DE ÎNĂLȚIME P+4E+PENTHOUSE CU FUNCȚIUNI COMPLEMENTARE LA PARTER</b>	PL. NR.:	U.08
TITLUL PLANȘEI:	<b>STUDIUL DE INSORIRE</b>		

SPECIFICATIE	NUME	SEMNĂTURĂ	DATA
ȘEF PROIECT	Arh. Urb. Stămorean Daniel		10/2018
PROIECTAT	Arh. Fricș Anikó Timea		SCARA
DESENAT	Arh.stag. Groza Maria Angelina		