

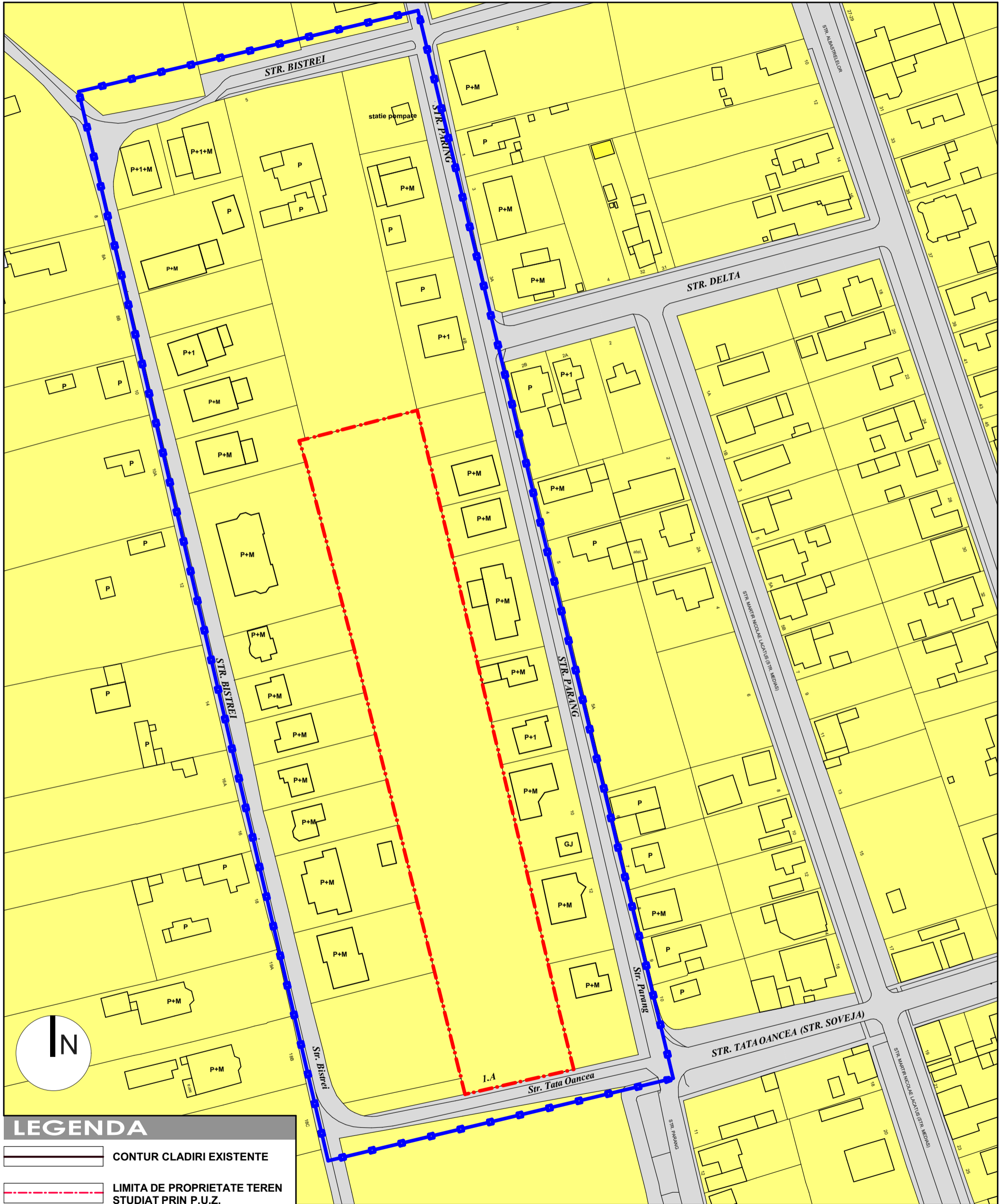





# 03. situatie existenta

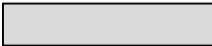

## LEGENDA

-  CONTUR CLADIRI EXISTENTE
-  LIMITA DE PROPRIETATE TEREN STUDIAT PRIN P.U.Z.
-  LIMITA ZONEI STUDIATA PRIN P.U.Z.
-  PIETONALE SI CAROSABILE EXISTENTE
-  ZONE SI CONSTRUCTII PENTRU LOCUINTE CU MAXIM 2 FAMILII SI FUNCTIUNI COMPLEMENTARE

|  |                   |   |               |   |  |                            |
|--|-------------------|---|---------------|---|--|----------------------------|
| <b>SYNAPSE</b><br><br>studio.srl |                   | PROIECTARE DE ARHITECTURĂ   |               | BENEFICIARI: GUTA DANA DOINA, BOC NICHIFOR si CHIRILOIU ALINA ELENA                                     |  | Proiect: 26/2019           |
|  |                   | Timisoara, jud. Timis<br>Str. Zlatna, Nr. 4, Sc. C, Ap. 8, Cam. 2<br>balos.adrian@gmail.com<br>tel. 0728.123313 |               | SPECIALITATEA: ARHITECTURA  |  |                            |
| SPECIFICATIE   | NUME              | SEMNTATURA  | Scara:        | PROIECT: PUZ - Parcelare teren si construire locuinte individuale<br>Timisoara, str. Tata Oancea nr. 1A |  | Faza: Aviz de oportunitate |
| SEF PROIECT  | arh. Sabin RACIU  |   | 1:1.000       | TITLU PLANSA: Situatie existenta  |  | PI. nr: A.03               |
| PROIECTAT / DESENAT  | arh. Adrian BALOȘ |   | Data: 12.2019 |   |  |                            |