

SOLSTITIUL DE IARNA

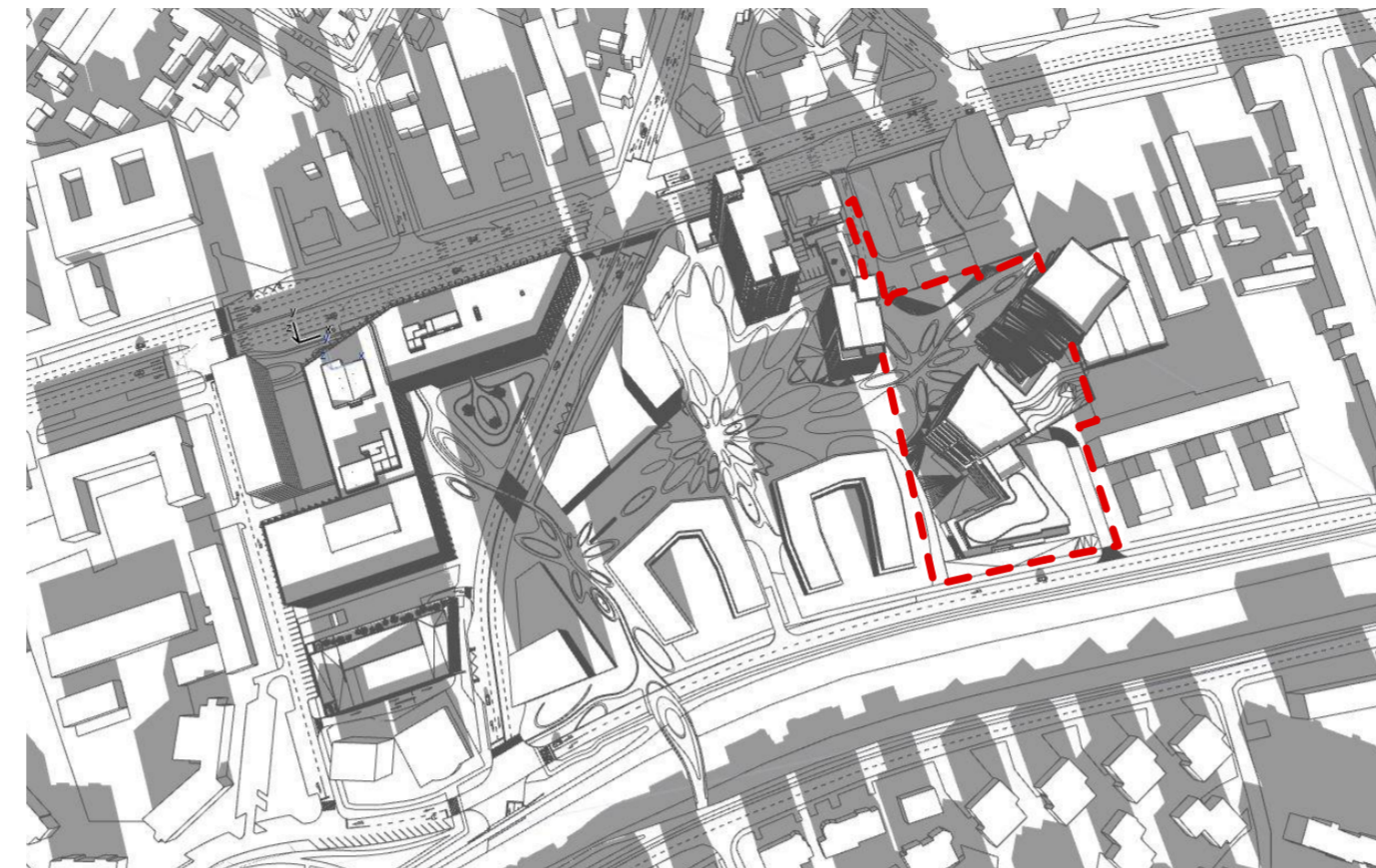

ORA 10:00



ORA 11:00



ORA 12:00

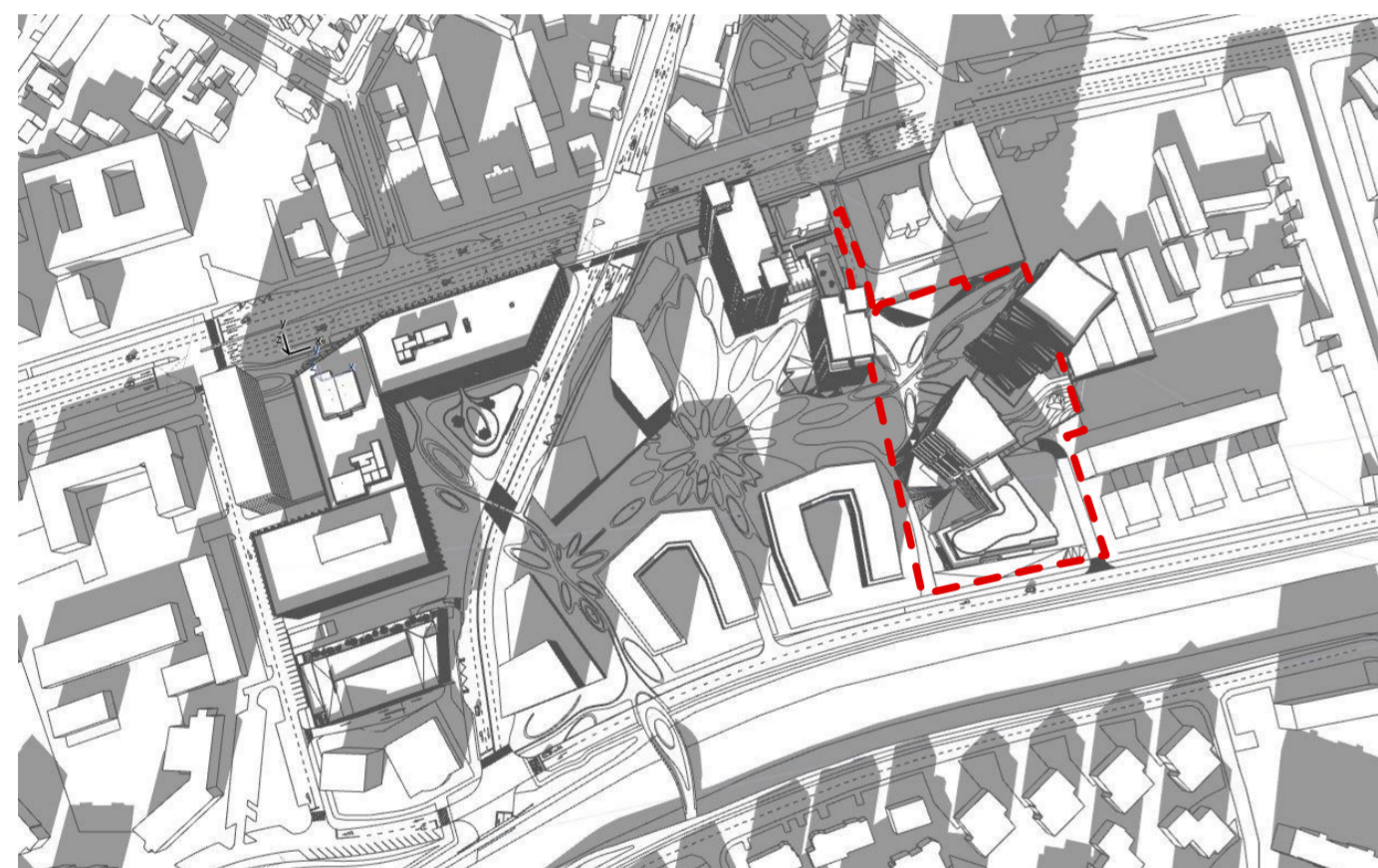

ORA 13:00

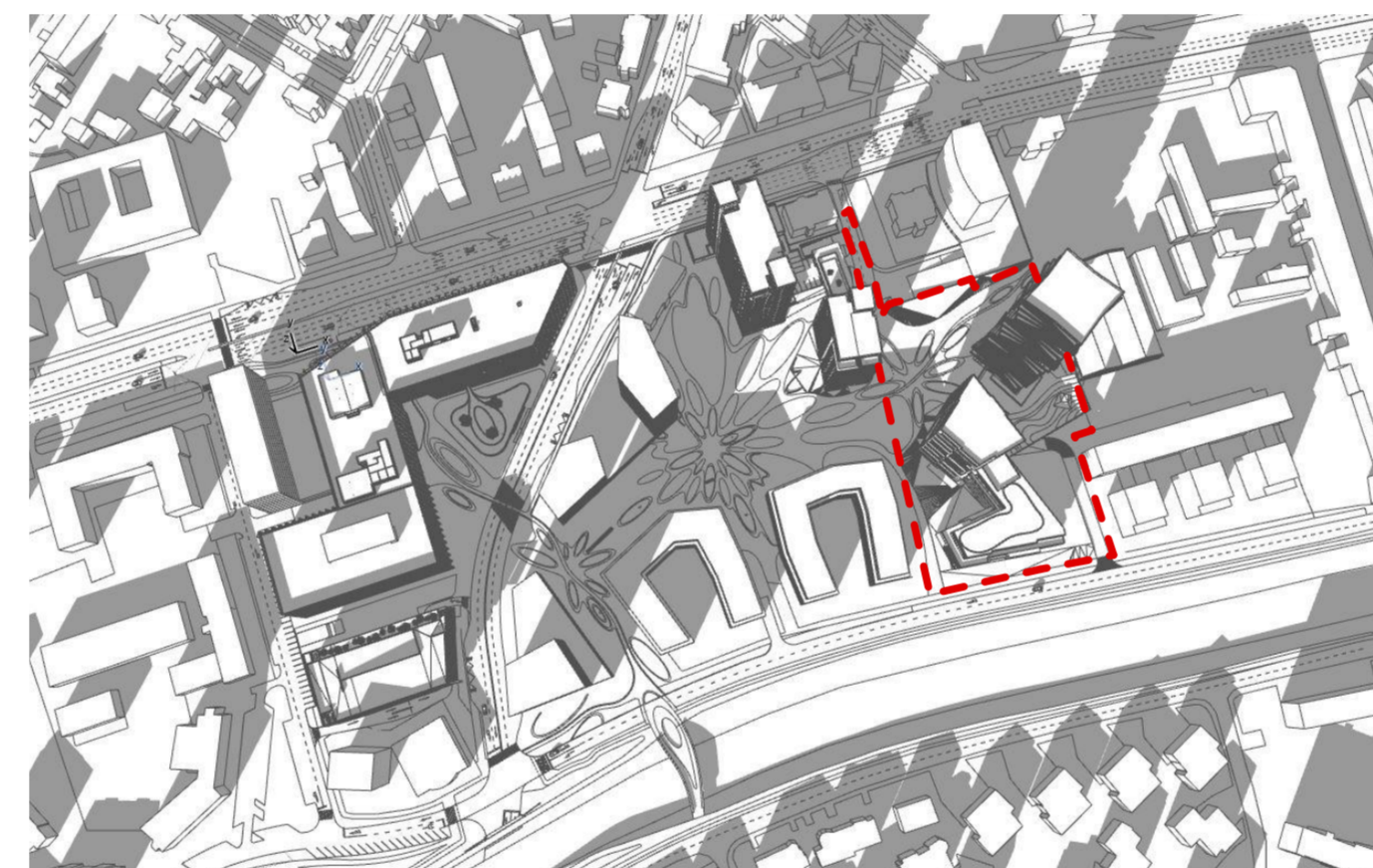

ORA 14:00

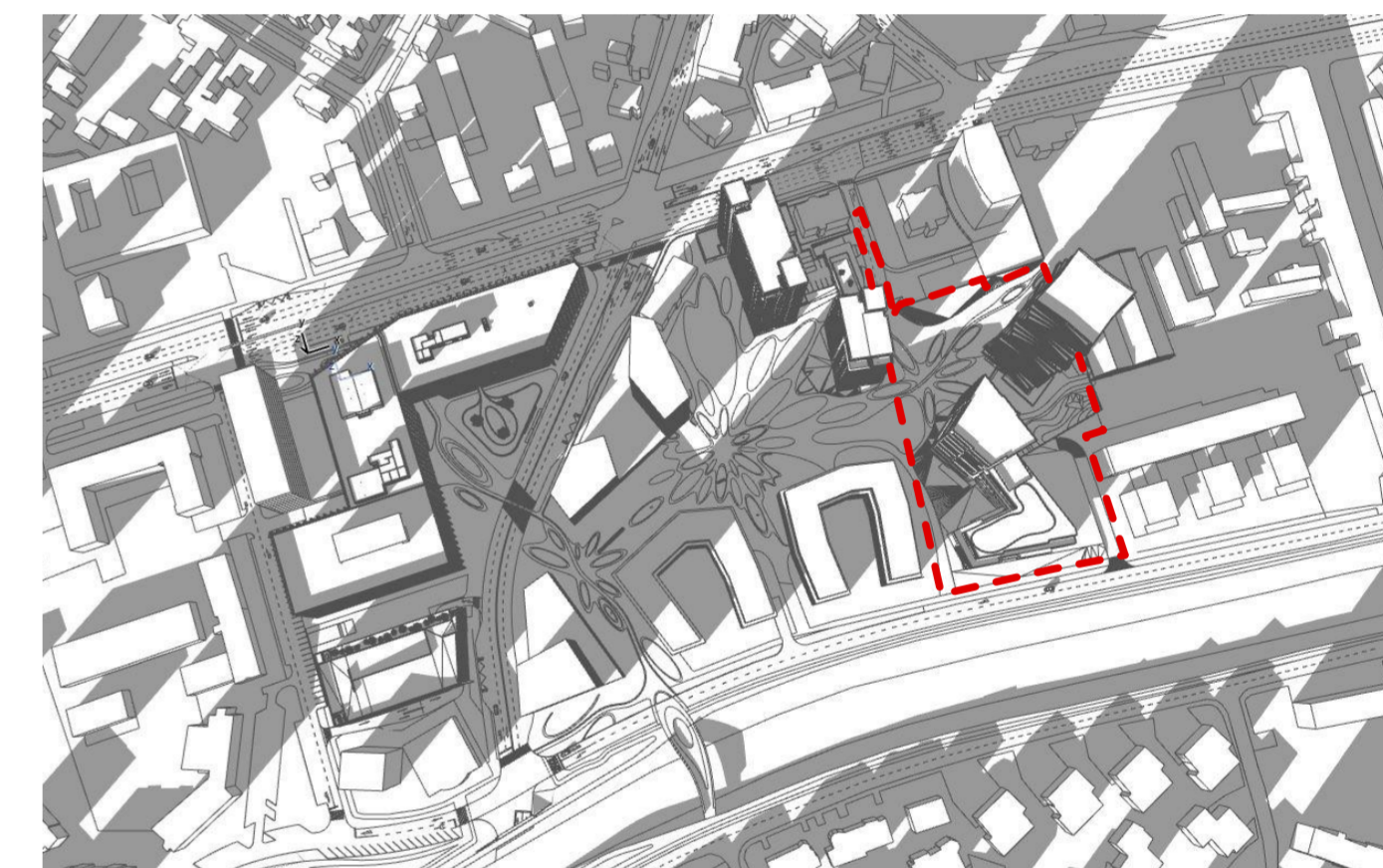

ORA 15:00



ORA 16:00

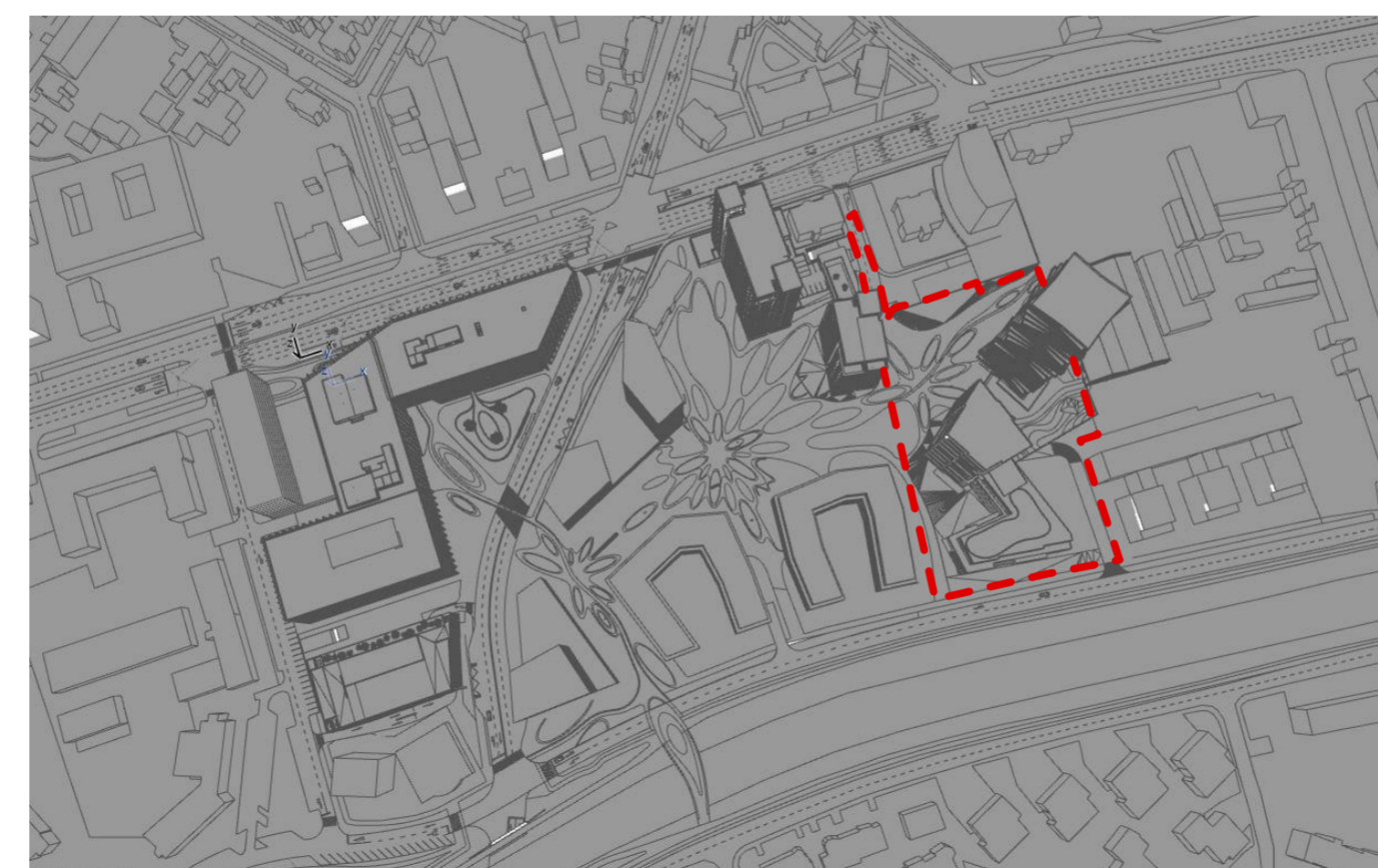

ORA 17:00

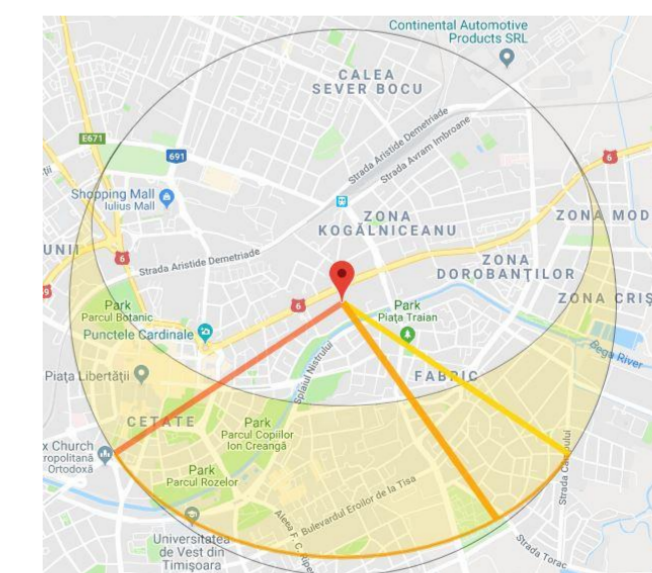

- 00:00—06:25 — night
- 06:25—07:01 — astronomical twilight
- 07:01—07:39 — nautical twilight
- 07:39—08:14 — civil twilight
- 08:14—08:17 — sunrise
- 08:17—16:50 — daylight
- 16:50—16:54 — sunset
- 16:54—17:28 — civil twilight
- 17:28—18:06 — nautical twilight
- 18:06—18:42 — astronomical twilight
- 18:42—00:00 — night

Traectoria soarelui, 45°45' Lat. Nordica 21°14' Long. Estica
- Solstitiul de iarna (21 decembrie) cea mai scurta zi a anului.

OBSERVATII:
Cladirile propuse respecta art. 3, alin. 1 din OMS 119/2014, si anume "Amplasarea cladirilor destinate locuintelor trebuie sa asigure insorirea acestora pe o durata de minimum 1 1/2 ore la solstitiul de iarna, a incaperilor de locuitdin cladire si din locuintele invecinate."

PROIECTANT: S.C. Atelier21 S.R.L. Splaiul Tudor Vladimirescu, Nr. 6, Ap.6, Timisoara, C.U.I. RO 17158898 e-mail: adina@atelier21.ro, tel. 0722.718.802	BENEFICIAR: S.C. TAKE PROJECT S.A. Timisoara, str. Take Ionescu, nr. 46C, ap. P.1 C.U.I. : 3500233, tel 0256491042, fax 0256491043	DESENAT: arh. Silvia Crisan	PROIECTAT: arh. Dan Munteanu
	DENUMIRE PROIECT: PUZ ILSA II Zona mixta- locuinte colective, spatii expozitionale, servicii, birouri si parcaje	COORDONATOR: arh. Petrisor Ageu	SEF PROIECT: arh. Adina Szitar
	AMPLASAMENT: B-dul Take Ionescu, nr. 46B, Timisoara, C.F. 432250, C.F. 432251, C.F. 432252, C.F. 432253, C.F. 432327, C.F. 432328	NR. PROIECT: 265 / 2018	FAZA PROIECT: PUZ
	DATA: Sept. 2018	DENUMIRE PLANSA: STUDIU INSORIRE	SCARA: PLANSĂ NR: 08.1.U