

PUD - Amplasare cladire in regim de inaltime P+2E (spatii comerciale si servicii de tip apart hotel)

PLAN - ANALIZA SITUATIEI EXISTENTE

Sc. 1:500

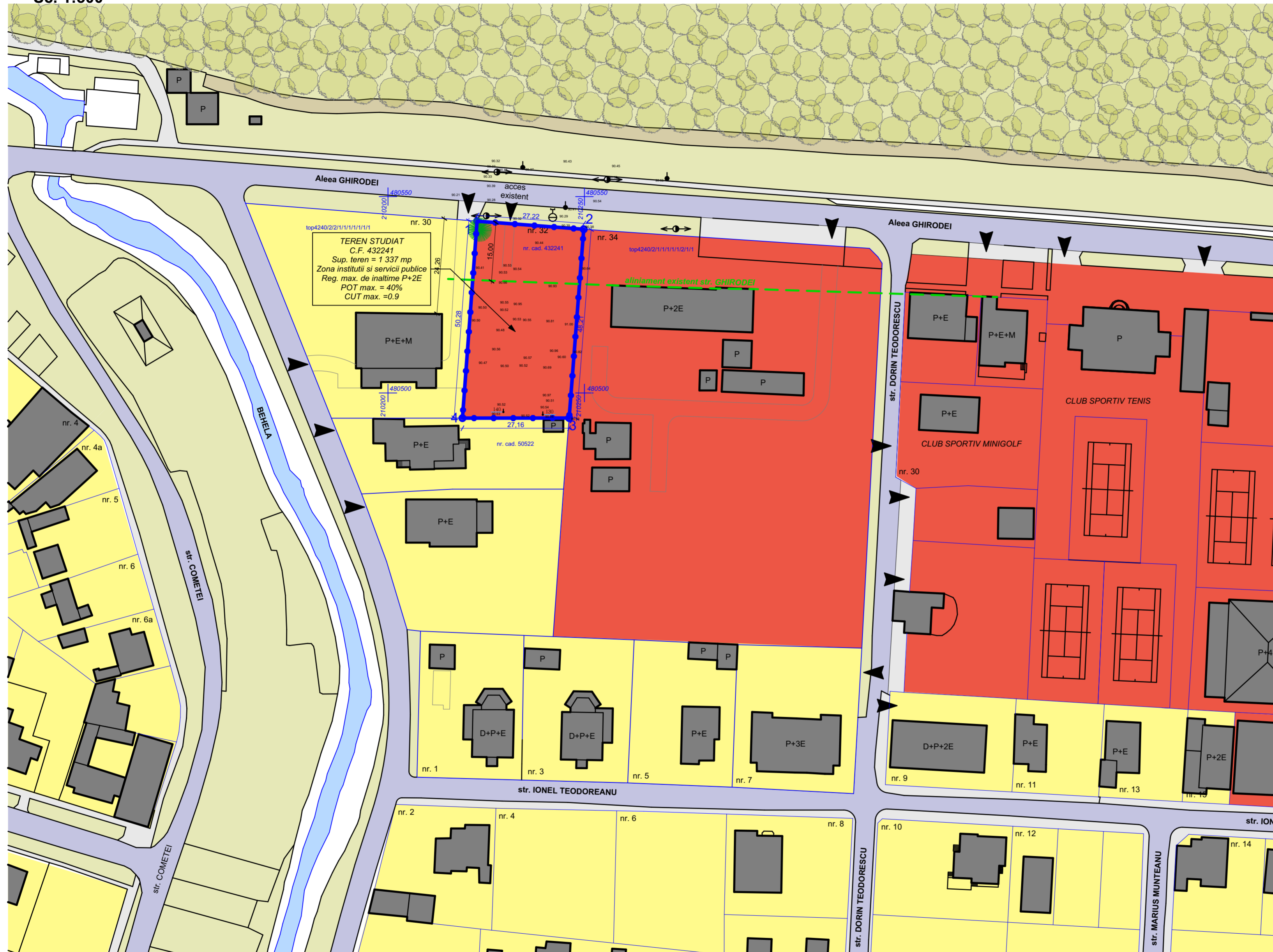

PLAN DE INCADRARE IN TERITORIU

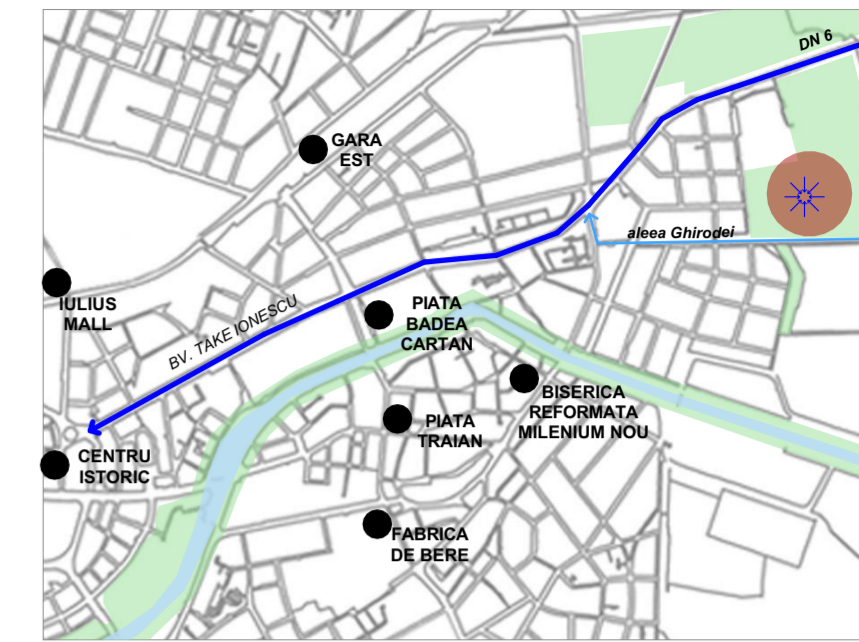

LEGENDA :

LIMITE / ACESE

- Limita zona reglementata
- Limite cadastrale
- Limita de constructibilitate/ retrageri
- Acces auto si pietonal existent/ propus

ZONIFICARE FUNCTIONALA

- Zona verde existenta
- Padure existenta
- Zona locuinte cu functiuni complementare, P-P+2
- Zona institutii si servicii publice
- Drumuri existente

P.O.T. maxim existent = 40% (conf. HG 525/1996)
C.U.T. maxim existent = 0,9

Regim maxim de inaltime existent: P+2E (conf. HG 525/1996)
Inaltime maxima la cornisa - 11,00 m
Inaltime maxima cladiri - 15,00 m

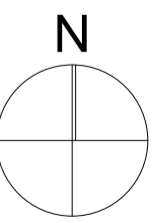

INVENTAR DE COORDONATE

Pct.	X	Y	Z
1	480543.741	210222.675	90.41
2	480541.683	210249.815	90.38
3	480493.614	210246.105	90.59
4	480493.595	210218.949	90.45

PROIECTANT: S.C. Atelier21 S.R.L.	BENEFICIAR: sc PROSPERO srl Timisoara, str. LUNCANI nr. 24	DESENAT: arh. Silvia Crisan	
Splaiul Tudor Vladimirescu, Nr. 6, Ap.6, Timisoara, C.U.I. RO 17158898 e-mail: adina@atelier21.ro, tel. 0722.718.802	DENUMIRE PROIECT: PUD - Amplasare cladire in regim de inaltime P+2E (spatii comerciale si servicii de tip apart hotel)	COORDONATOR: arh. Silvia Crisan	FAZA PROIECT: PUD
	AMPLASAMENT: Aleea GHIRODEI, nr. 32, TIMISOARA, jud. TIMIS - CF 432241, nr. cad 432241	SEF PROIECT: arh. Adina Szitar	NR. PROIECT: 248 / 2019
			DENUMIRE PLANSA: PLAN SITUATIA EXISTENTA
		DATA: Sep. 2020	SCARA: 1:750
			PLANSA NR: 03.U