

PLAN TOPOGRAFIC

SCARA 1: 5000

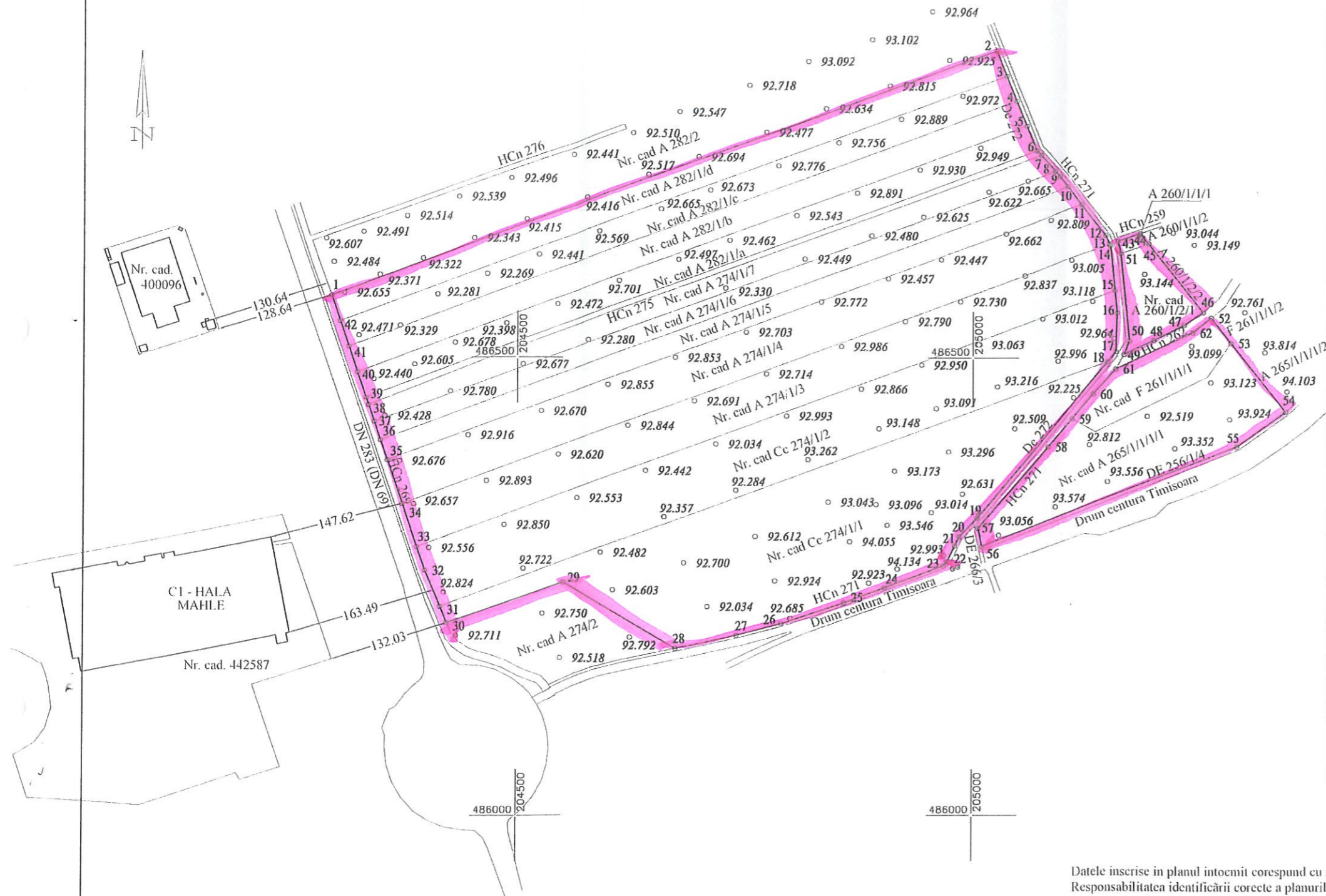

Nr. Pct.	Coordonate pct.de contur		Lungimi latari D(i,i+1)
	X [m]	Y [m]	
1	486567.550	204295.853	777.04
2	486834.999	205025.418	29.49
3	486807.661	205036.470	29.42
4	486780.383	205047.497	29.36
5	486753.163	205058.501	29.25
6	486726.047	205069.463	7.07
7	486721.174	205074.580	23.94
8	486703.146	205090.335	7.96
9	486697.151	205095.575	14.63
10	486685.822	205104.836	24.50
11	486666.855	205120.341	42.32
12	486634.087	205147.128	10.70
13	486624.350	205151.564	2.07
14	486622.468	205152.421	49.31
15	486573.406	205157.322	24.18
16	486549.342	205159.725	42.55
17	486506.806	205158.478	14.26
18	486495.886	205149.303	224.18
19	486324.247	205005.092	28.23
20	486304.079	204985.337	11.49
21	486293.802	204980.188	19.31
22	486276.416	204971.789	6.17
23	486271.951	204967.529	68.54
24	486248.299	204903.196	47.03
25	486231.750	204859.169	72.19
26	486209.148	204790.613	50.59
27	486196.432	204741.644	68.53
28	486182.088	204674.628	142.58
29	486253.826	204551.415	135.75
30	486209.581	204423.081	19.48
31	486227.528	204415.507	42.81
32	486266.969	204398.863	27.30
33	486292.784	204389.992	49.83
34	486339.911	204373.797	50.65
35	486387.815	204357.336	23.14
36	486409.702	204349.815	21.25
37	486429.803	204342.907	19.30
38	486448.057	204336.635	8.77
39	486456.285	204333.593	29.24
40	486483.978	204324.200	29.35
41	486511.776	204314.771	29.42
42	486539.633	204305.323	29.48

Nr. Pct.	Coordonate pct.de contur		Lungimi latari D(i,i+1)
	X [m]	Y [m]	
43	486627.571	205160.621	25.94
44	486636.117	205185.116	14.54
45	486624.746	205194.177	96.08
46	486549.603	205254.048	25.18
47	486535.851	205232.951	36.82
48	486519.423	205199.999	36.07
49	486503.935	205167.419	15.99
50	486518.815	205173.286	95.76
51	486614.085	205163.620	13.82

Nr. Pct.	Coordonate pct.de contur		Lungimi latari D(i,i+1)
	X [m]	Y [m]	
52	486543.546	205262.956	35.10
53	486516.090	205284.830	96.24
54	486440.820	205344.800	65.64
55	486402.765	205291.317	301.81
56	486293.513	205009.970	20.35
57	486313.444	205005.856	117.88
58	486402.457	205083.134	40.66
59	486433.036	205109.937	36.18
60	486460.582	205133.386	37.28
61	486488.189	205158.437	92.87
62	486527.655	205242.509	25.90



Datele inscrise in planul intocmit corespund cu realitatea din teren.
Responsabilitatea identificării corecte a planurilor parcelare si a determinărilor topografice REVINE in totalitate persoanei autorizate

SC TOP-AS SRL, prin ing. ALBULESCU CONSTANTIN Persoană fizică autorizată de A.N.C.P.I. cat.A Certificat de autorizare seria RO-B-J NR.0583		RIDICARE TOPOGRAFICA A TERENULUI SITUAT IN EXTRAVILANUL MUN. TIMISOARA BENEFICIAR: SC BRAURON CONSTRUCT SRL		Lucrare nr. 239/2017
	Nume	Scara		
Sef proiect	ing. Albulescu C.	1:5000	PLAN TOPOGRAFIC	
Verificat				
Întocmit				
Desenat				
		APRILIE 2018	PLANSĂ NR. 1	